

Filtration Manufacturing, Inc.

47 J. Faris Drive

Andalusia, AL 36421

Phone: (800) 239-8413

Fax: (800) 239-9798



Plastic Filter Housings, Counter Top
Filters and Accessories

Plastic Filter Housings

Top quality and economically priced plastic filter housings in generic packaging.



Buttress thread design

Provides superior sealing and greater security.

Heavy Duty Construction

Housings are made entirely of the highest quality FDA grade NSF listed polypropylene.



Features & benefits

- Full product line for more types, models, pipe fittings and options than anyone in the business!
- Heavy duty construction, made using high quality FDA grade polypropylene.
- Superior chemical resistance from many aggressive chemicals.
- Buttress thread design for superior sealing and security.
- Thick side walls with heavy-duty ribs to provide greater strength.
- Temperature rated to 125°F (52°C).
- Pressure rated to 125 psi (8.75 bar).
- Cap, sump and top-seated o-rings compress to provide leak proof sealing.
- NSF Standard 42 certified (FH4200WW14, FH4200BB14, FH4200WW34).



ANSI / NSF 42
CERTIFIED
FH4200WW14
FH4200WW34
FH4200BB14

Dimensions

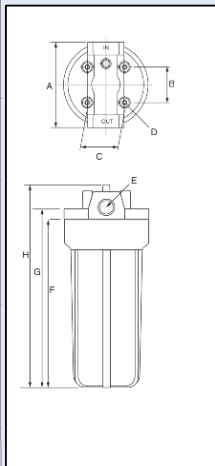

| Model | Size | A | B | C | D | E | F | G | H |
|-----------------|------|-------|-------|-------|--------|---|--------|--------|-------|
| 500 Series | 5" | 4.28" | 1.57" | 1.18" | 0.16" | X | 5.7" | 7.0" | 7.5" |
| 4000 Series | 10" | 4.72" | 1.57" | 1.18" | 1.18" | X | 10.5" | 11.0" | 11.8" |
| 4200 Series | 10" | 4.72" | 1.57" | 1.18" | 1.18" | X | 10.5" | 11.0" | 11.8" |
| 7000 Series | 20" | 4.72" | 1.57" | 1.18" | 1.18" | X | 20.47" | 21.26" | 22.8" |
| 4500 Series | 10" | 5.35" | 2.22" | 2.28" | 0.23" | X | 10.43" | 11.49" | 12.5" |
| 8000 Series | 20" | 5.35" | 2.22" | 2.28" | 0.23" | X | 20.47" | 21.26" | 22.8" |
| Full-Filt (B-B) | 10" | 7.28" | 3.03" | 3.03" | 0.275" | X | 11.33" | 11.57" | 14.0" |
| Full-Filt (B-B) | 20" | 7.28" | 3.03" | 3.03" | 0.275" | X | 21.25" | 21.65" | 24.0" |

x = Depends on size of pipe fitting selected

Types & Models



Residential Series
4200 (10") & 7000 (20")



Commercial Series
4500 (10") & 8000 (20")



Full-Filt (B-B) Series
5000 (10") & 10000 (20")



Valve-In-Head
Opaque & Clear



High Temp
4500HT (10") & 8000HT (20")



Virgin Polypro
DOE & "222"



White



Black



Blue / Black



Clear

Specifications

| | |
|---------------------------------|-------------------------------------------------------|
| Material, sumps & caps | FDA grade polypropylene. |
| Material, o-rings | EPDM is standard; Viton is available as a spare part. |
| Maximum temperature (standard) | 125° F (52°C) |
| Maximum temperature (high temp) | 200°F (93°C) |
| Minimum temperature | 40°F (4°C) |
| Maximum pressure (standard) | 125 psi (8.75 bar) |
| Maximum pressure (full flow) | 90 psi (6.3 bar) |
| Burst test | Tested to 500 psi. (150,000 cycles from 0 to 125 psi) |



High-Temp housings (rated for temperatures to 200°F (93°C)).

| Model Number | Size | PR | Sump | Cap | Pipe Size | No./ case | Shipping Wt. (Lbs.) | Carton Size (") |
|-----------------|------|----|------|-----|-----------|-----------|---------------------|-----------------|
| 5001-HD4500HT34 | 10" | No | Red | Red | 3/4" | 12 | 50 | 22x17x13 |
| 5001-FH8000HT34 | 20" | No | Red | Red | 3/4" | 12 | 44 | 18x12x24 |



All black housings

| Model Number | Size | PR | Sump | Cap | Pipe Size | No./ case | Shipping Wt. (Lbs.) | Carton Size (") |
|-------------------|------|-----|-------|-------|-----------|-----------|---------------------|-----------------|
| 5001-FH4200BB14 | 10" | No | Black | Black | 1/4" | 12 | 24 | 19x14x13 |
| 5001-FH4200BB34 | 10" | No | Black | Black | 3/4" | 12 | 24 | 19x14x13 |
| 5001-HD4500BB34PR | 10" | Yes | Black | Black | 3/4" | 12 | 38 | 22x17x13 |
| 5001-FH8000BB34PR | 20" | Yes | Black | Black | 3/4" | 6 | 33 | 18x12x24 |
| 5001-FH5000BB1PR | 10BB | Yes | Black | Black | 1" | 4 | 22 | 16x16x14 |
| 5001-FH10000BB1PR | 20BB | Yes | Black | Black | 1" | 4 | 35 | 16x16x26 |

10" Residential Blue / Black housings

| Model Number | Size | PR | Sump | Cap | Pipe Size | No./ case | Shipping Wt. (Lbs.) | Carton Size (") |
|-------------------|------|-----|------|-------|-----------|-----------|---------------------|-----------------|
| 5001-FH4200BL14 | 10" | No | Blue | Black | 1/4" | 12 | 24 | 19x14x13 |
| 5001-FH4200BL14PR | 10" | Yes | Blue | Black | 1/4" | 12 | 24 | 19x14x13 |
| 5001-FH4200BL38 | 10" | No | Blue | Black | 3/8" | 12 | 24 | 19x14x13 |
| 5001-FH4200BL38PR | 10" | Yes | Blue | Black | 3/8" | 12 | 24 | 19x13x13 |
| 5001-FH4200BL12 | 10" | No | Blue | Black | 1/2" | 12 | 24 | 19x14x13 |
| 5001-FH4200BL12PR | 10" | Yes | Blue | Black | 1/2" | 12 | 24 | 19x14x13 |
| 5001-FH4200BL34 | 10" | No | Blue | Black | 3/4" | 12 | 24 | 19x14x13 |
| 5001-FH4200BL34PR | 10" | Yes | Blue | Black | 3/4" | 12 | 24 | 19x13x13 |